

# How to Determine Your Address

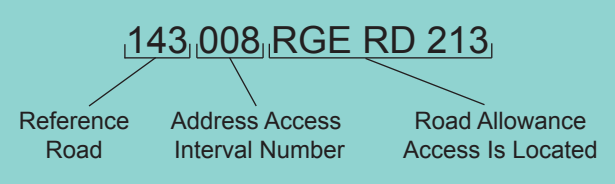

Addresses are based on the location of the *primary access* along a road allowance.

Each mile of road is divided into intervals of 40 metres, with numbers increasing from South to North and East to West. Even numbers are along the North and West sides of a road allowance, and Odd numbers are along the South and East.

For the purposes of addressing, virtual township roads exist between all sections, whether an actual road allowance exists or not.

**Example #1: 143008 RGE RD 213**

The access is along the west side of Rge Rd 213. It's located in address interval 8. 143 is the intersecting Twp Rd number to the south.

**Example #2: 213033 TWP RD 144**

When there are multiple accesses, the primary access is used. In this case, the access is along the south side of Twp Rd 144. 213 is the intersecting Rge Rd to the east, and 33 is the interval the primary access is in.

**Example #3: 143032 RGE RD 213**

When there are multiple accesses along the same side of a road allowance and no clear primary access, the first access is chosen.

**Example #4: 143072 RGE RD 213**

When there is one access along a Twp Rd, one access along a Rge Rd, and no clear primary access, the one along the Rge Rd is chosen.

**Example #5: 143009A & 143009B RGE RD 214**

When there are multiple residences located off the same primary access, the first building off the access is designated "A", the second building is designated "B", and so forth.

**Example #6: 5, 12, 16 & 21 - 143047 RGE RD 214**

Subdivision addresses are also based on the location of the primary access on a road allowance. The lots are numbered clockwise using an increment of 4, with odd numbers along the South and East and even along the North and South (if possible).

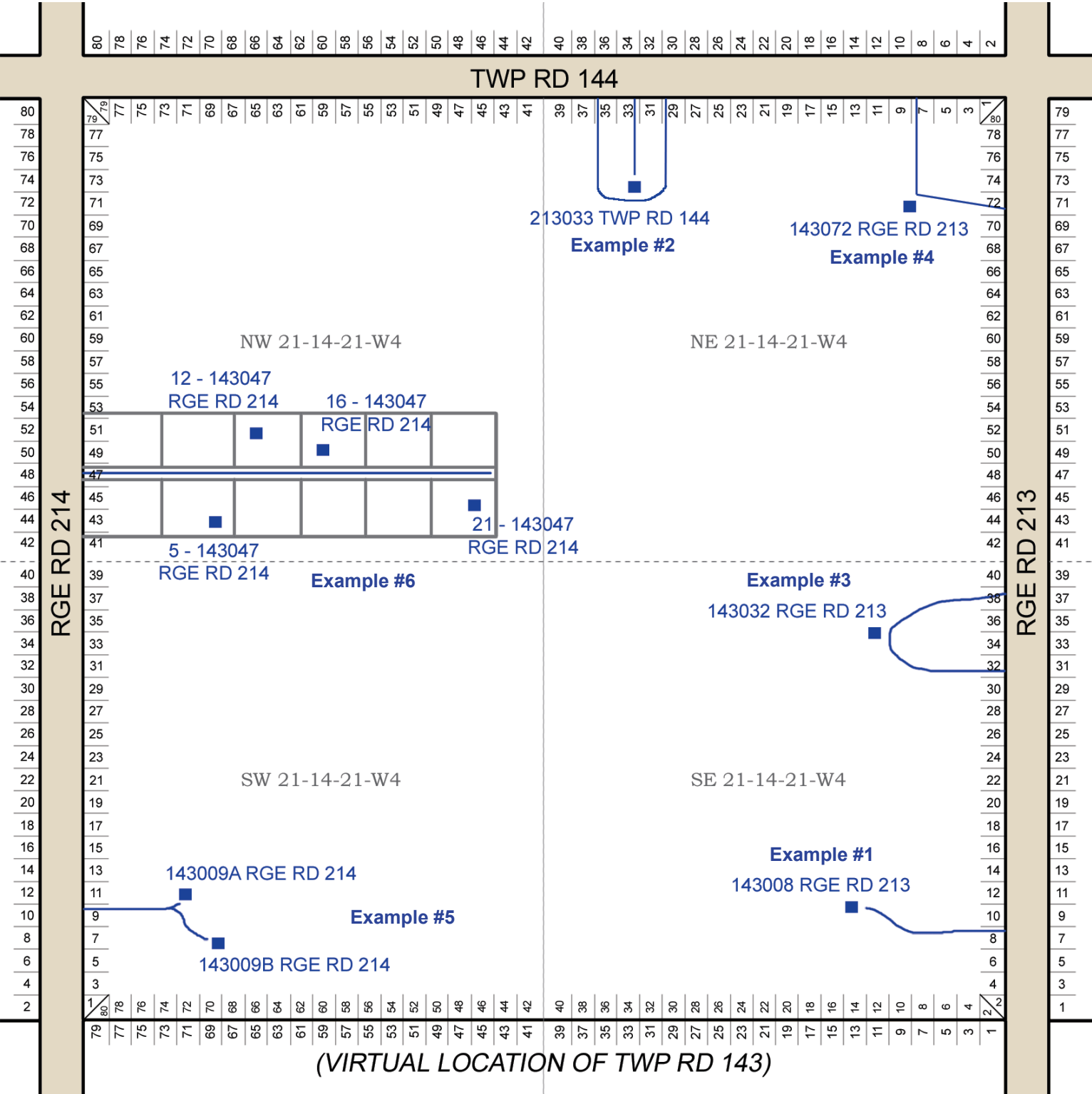

(VIRTUAL LOCATION OF TWP RD 143)